

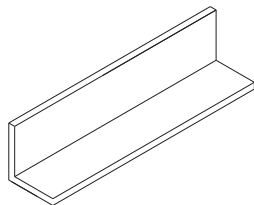

Ferro Cantoneira

Medidas	Peso
1/2X1/8	3.36
5/8X1/8	4.38
3/4X1/8	5.16
7/8X1/8	6.24
1X1/8	7.62
1X3/16	10.38
1X1/4	13.54
1.1/4X1/8	9.12
1.1/4X3/16	13.14
1.1/4X1/4	17.45
1.1/2X1/8	10.98
1.1/2X3/16	15.96
1.1/2X1/4	21.41
1.3/4X1/8	13.30
1.3/4X3/16	19.46
1.3/4X1/4	25.38
2X1/8	14.76
2X3/16	21.78
2X1/4	29.22
2X5/16	35.87
2X3/8	42.27
2.1/2X3/16	28.30
2.1/2X1/4	37.09
2.1/2X5/16	45.69
2.1/2X3/8	54.05
3X3/16	34.10
3X1/4	44.84
3X5/16	55.33
3X3/8	65.88
4X1/4	60,57
4X5/16	75,03



Ferro Tee

Medidas	Peso
5/8X1/8	4.33
3/4X1/8	5.46
7/8X1/8	6.54
1X1/8	7.56
1.1/4X1/8	9.72

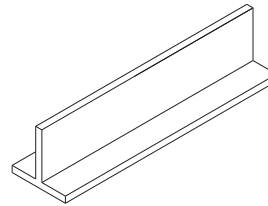

Ferro Quadrado

Medidas	Peso
1/4"	1.90
5/16"	3.05
3/8"	4.26
1/2"	7.62
5/8"	11.88
3/4"	17.10
7/8"	23.22
1"	30.36

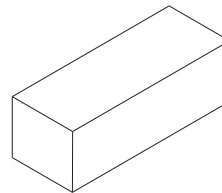

Ferro Redondo

Medidas	Peso
1/4"	1.50
5/16"	2.45
3/8"	3.36
15/32"	3.60
1/2"	5.94
5/8"	9.30
3/4"	13.44
7/8"	18.61
1"	24.28
1 1/14"	37,94
1 1/2"	54,60

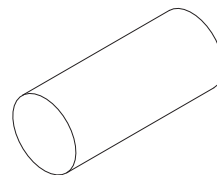

COPERFIL

ISO 9001:2000